

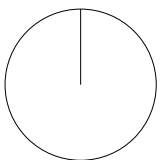







## Tender DRAFT



Key

|   |   |   |  |
|---|---|---|--|
|  | Demolition  |  | Remove and retain for re-installment                       |
|  | Excavation (Refer to structural & services eng. information)      |  | BWIC in wall   |
|  | Removal of structural slab/ roof (in plan) or wall (in elevation) |  | BWIC in slab   |
|   |   |  | Strip out works<br>(By others, not included in main works) |

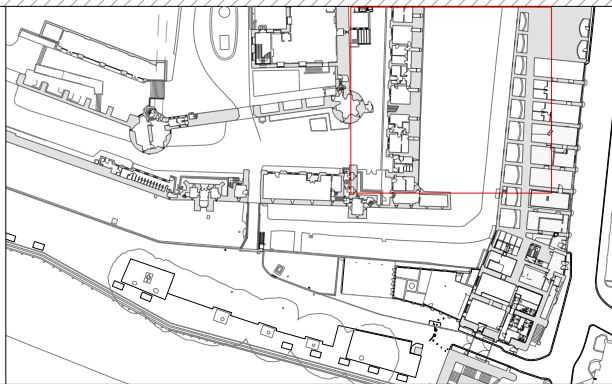

**General Notes:**

To be read in conjunction with Service Engineer, Structural Engineers and Heritage Architects Information.

Drawings are based on survey data and may not accurately represent what is physically present.

**All areas and methodologies are subject to full condition survey following strip out.**

**All demolition and proposed works are to be undertaken in adherence to SMC conditions and Listed Building Consent conditions.**

**Jamie Fobert**  
— Architects  
Rochelle, 22 Club Row  
London E2 7EY  
T: +44 (0) 207 553 6560  
mail@jamiefobertarchitects.com

|   |          |     |               |                                      |
|---|----------|-----|---------------|--------------------------------------|
| Unless indicated below, this drawing is for information only.<br>Do not scale. Use figured dimensions only. All dimensions to be checked on site. |          |     | Project       | The Tower of London                  |
| Issue/Revision  | Date     | Rev | Subject       | Arches Demolition Moat Level (North) |
| Stage 4A  | 17 04 25 | A   | Scale         | 1:100                                |
| Stage 4   | 18 07 25 | B   | Original Size | A1                                   |
| Tender DRAFT  | 24 10 25 | C   | Date          | 03 12 24                             |
|   |          |     | Drawing No.   | TOL -JFA-01-UB-DW-A-0110             |